

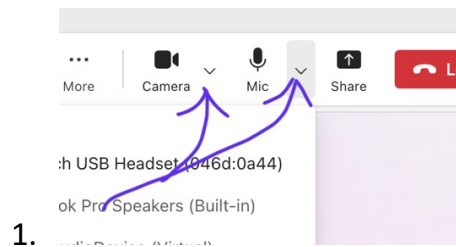

EME2172 Equipment Guide

1. Use the remote to turn on the TV.
2. Connect the HDMI cable to your laptop to share your laptop content.
3. For ZOOM or MS Teams: Connect the USB cable to your laptop in order to use the room camera and microphone.
4. Start your app (e.g. ZOOM or MS Teams or similar) and begin your call, then in the app settings select "**Poly P15**" for the camera and speakers and microphone.

a. e.g. MS Teams:



b. e.g. ZOOM:

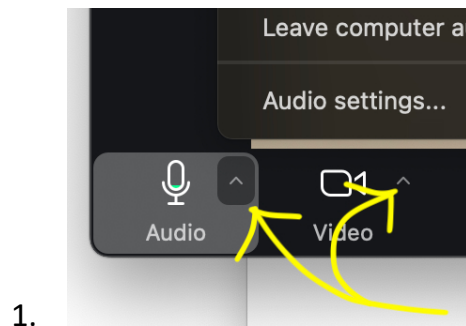

5. At the end of your meeting, please turn off the TV.

